

Exterior-Steel Frame-Single Stud- CSR Hebel Facade
(Shown with 10mm Gyprock)

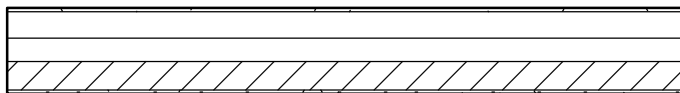
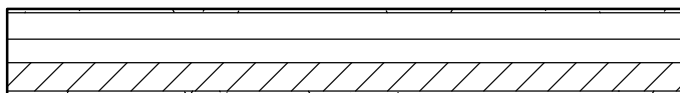

Wall Schedule				
Wall Name	Manufacturer	Wall Height 'H'	Fire Rating (FRL)	Acoustic Rating (Rw+Ctr)
Exterior-Steel Frame-Single Stud-CSR Hebel Facade HEB 2000-227mm	CSR HEBEL	Varies	-/120/120	Rw+Ctr 36dB
Exterior-Steel Frame-Single Stud-CSR Hebel Facade HEB 2001-227mm	CSR HEBEL	Varies	-/180/180	Rw+Ctr 36dB

Refer to the Hebel Design and Installation Guide

CSR BUILDING PRODUCTS LTD

Head Office: Trinit 3, 39 DELHI RD, NORTH RYDE NSW 2113
LOCKED BAG 1345, NORTH RYDE BC NSW 1670
A.B.N. 55 008 631 356 Ph: 1300 306 556 www.hebelaustralia.com.au

TITLE Exterior-Steel Frame-Single Stud- CSR Hebel Facade

SCALE 1:20 @ A4

SHEET SIZE A4

DRAWN DA

DATE 11.03.13

DESIGN GUIDE REFERENCE
HEB1269 JULY 2012

SHEET NO.
1 of 1

CHECK DL

REVISION
A

CSR